

“Creating A Cleaner World”

through



JUBILEE
Environmental Products, LLC

406 S. Boulder, Suite 820
Tulsa, OK 74103
918-587-3948 (P)
918-295-9903 (F)
www.jep14.com

JEP-1

HEAVY DUTY INDUSTRIAL CLEANER/DEGREASER

PATENTED DESIGN FEATURES

- **Positive emulsion** — spontaneously emulsifies greasy soil to improve cleaning — prevents soil/dirt redeposition
- **Balanced builder blend** — sustained, buffered alkalinity and excellent rinseability
- **Surface safety** — built-in flash corrosion inhibitor
- **Worker safety** — contains no solvents, phosphates or Section 313 listed chemicals
- **USDA rating** — A-1

PROFESSIONAL RECOMMENDATIONS

- This is an excellent “catch-up” cleaner that will perform best when used regularly
- **Use** “grit” type brushes on your autoscrubber to enhance cleaning on unfinished concrete and other industrial floors
- Overlap your cleaning passes to assure uniform cleaning and “double scrub” when heavy soil is present
- When mop cleaning, change cleaning solution frequently to get peak cleaning performance. Do not let mop rest in cleaning solution between uses.
- If applying with a pressure washer, stay out of mist
- **Not** recommended for removal of baked-on or dried, hardened soils—use a cleaner that is solvent fortified

APPLICATION

Industrial heavy duty maintenance cleaner — floors, walls, machinery, hoods, sumps, vent systems through mechanical cleaning devices and dip-tank applications.

SPECIFICATIONS

- Appearance:** Clear, red liquid
Odor: Mild, characteristic
Density (lbs/gal)(±0.1 @20°C): 8.82
pH (Conc./1%)(±0.5@20°C): 13.2/11.6
Refractive index (±.0020@20°C): 1.3489
Hard water tolerance (as ppm CaCO₃): >2700 ppm
Solvent %: None
Flashpoint (TCC): None
USDA rating: A-1
Foam generation: Moderate
Stability (40°-120°F): Stable
Freeze/thaw stability: OK, 3 cycles
Shelf life (closed containers, 40°-120°F): 1 year minimum

DIRECTIONS



Wear safety equipment recommended on MSDS. Read all directions and cautions prior to beginning work. Remove loose soil and garbage. Divide floor into workable sections.

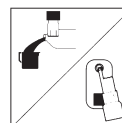

Dilute **JEP-1** with water as follows:
Heavy soil: 5:1 (26 oz. per gallon)
Moderate soil: 20:1 (6 oz. per gallon)
Light cleaning: 50:1 (2.5 oz. per gallon).



Apply to surface liberally while scrubbing. Allow to work. If soil is heavy, double scrub with an autoscrubber (First pass, squeegee up; second pass, squeegee down, vac on). Pick up as much solution as possible. If possible, allow floor to dry before traffic resumes on cleaned area.



For Pressure Cleaning: Draw concentrate directly from container. Set dilution using pressure washer manufacturer's directions according to soil present.



Wear safety equipment recommended on MSDS, place wet floor signs and read all directions and cautions prior to beginning work.