

“Creating A Cleaner World”

through

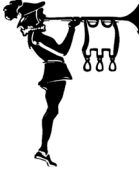

JUBILEE

Environmental Products, LLC

406 S. Boulder, Suite 820

Tulsa, OK 74103

918-587-3948 (P)

918-295-9903 (F)

www.jep14.com

JEP-7

CITRUS CLEANER/DEGREASER

PATENTED DESIGN FEATURES

- **Advanced detergent system** — fortified with natural citrus solvent
- **Balanced builder blend** — maintains alkalinity over side dilution range. Good hard water tolerance
- **Surface safety** — built-in corrosion inhibitor
- **USDA rating** — C-1

PROFESSIONAL RECOMMENDATIONS

- **Use** this product regularly for best results
- Rinse out autoscrubber lines after each use of this product to protect hoses
- Use "grit" type brushes on your autoscrubber to enhance cleaning on unfinished concrete and other industrial floors
- Overlap your cleaning passes to assure uniform cleaning and "double scrub" when heavy soil is present
- When mop cleaning, change cleaning solution frequently to get peak cleaning performance
- **Do not** let mop rest in cleaning solution between uses

APPLICATION

Commercial, industrial institutional maintenance cleaner. For all hard surfaces.

SPECIFICATIONS

Appearance: Clear, orange liquid

Odor: Citrus

Density (lbs/gal)(±0.1 @20°C): 8.68

pH (Conc./1%)(±0.5@20°C): 13.2/11.2

Refractive index (±.0020@20°C): 1.3514

Hard water tolerance (as ppm CaCO₃): >2000 ppm

Flashpoint (TCC): None

USDA rating: C-1

Foam generation: Moderate

Stability (40°-120°F): Stable

Freeze/thaw stability: OK, 3 cycles

Shelf life (closed containers, 40°-120°F): 1 year minimum

DIRECTIONS



Remove loose soil and garbage. Divide floor into workable sections.

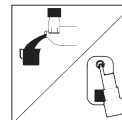

Dilute **JEP-7** with water as follows:
Heavy soil and rubber mark removal: 4:1 (32 oz. per gallon)
Normal cleaning: 20:1 (6 oz. per gallon).



Apply to surface liberally while scrubbing. Allow to work. If soil is heavy, double scrub with an autoscrubber (First pass, squeegee up; second pass, squeegee down, vac on). Pick up as much solution as possible.



If possible, allow floor to dry before traffic resumes on cleaned area.



Wear safety equipment recommended on MSDS, place wet floor signs and read all directions and cautions prior to beginning work.